

Technische Informationen

Technical information

Prüfungen und Normen

Tests and standards

| | |
|--|-----------------|
| Einbruchhemmung nach DIN V ENV 1627 | bis Klasse WK2 |
| Burglar resistance in accordance with DIN V ENV 1627 | Up to class WK2 |
| Luftdurchlässigkeit nach DIN EN 12207 | Klasse 2 |
| Air permeability in accordance with DIN EN 12207 | Class 2 |
| Windlastwiderstand nach DIN EN 12210 | bis Klasse C3 |
| Wind load resistance in accordance with DIN EN 12210 | Up to class C3 |
| Glasstärke | 4mm bis 40mm |
| Glass thickness | 4 mm to 40 mm |
| Geprüfte lichte Tür-Durchgangshöhe | bis 3000mm |
| Tested clear door opening height | Up to 3000 mm |

* Die Angaben beschreiben die Bestwerte des Gesamtsystems bei innen als auch außen öffnenden Ausführungen. Die Eigenschaften einer jeweils gewählten Ausführungsvariante oder Elementkombination sind im Einzelfall anhand der ausführlichen Prüfdokumentation zu bestimmen.

The information describes the optimum values of the entire system for both inward and outward-opening designs.

The properties of a selected design option or unit combination have to be determined individually based on the comprehensive test documentation.

Einfügelige Tür
Single-leaf door

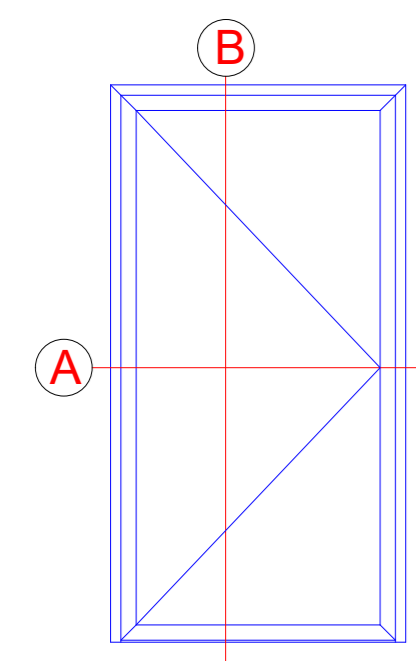

A

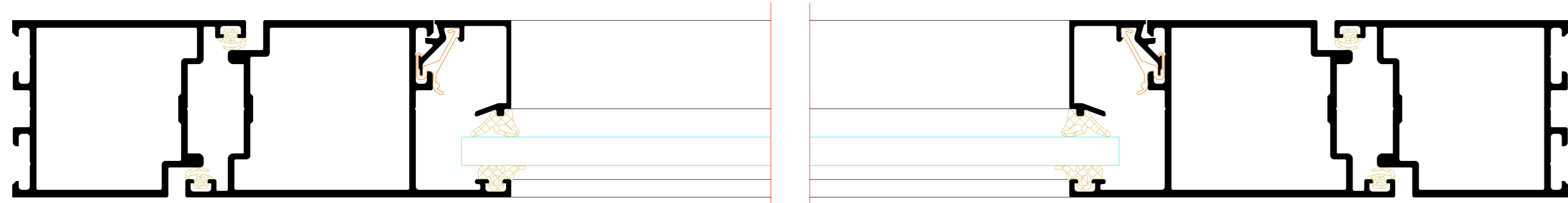

A

mit Klemmschutz
With finger-trap
protection

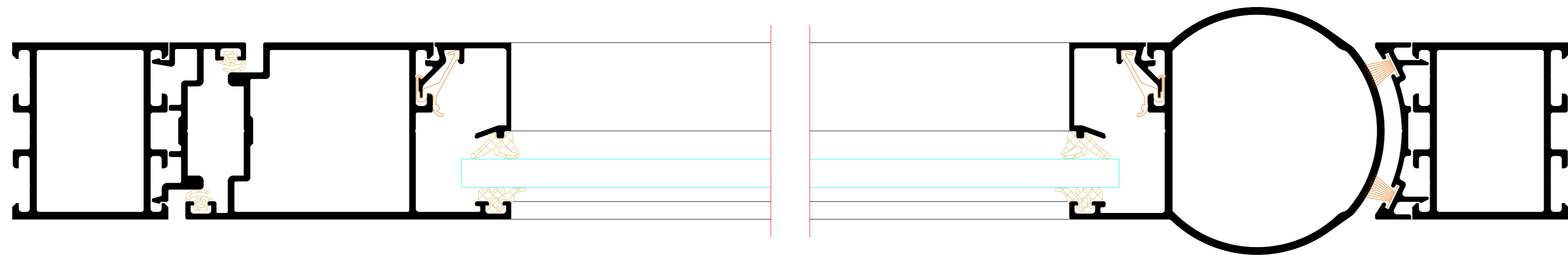

B

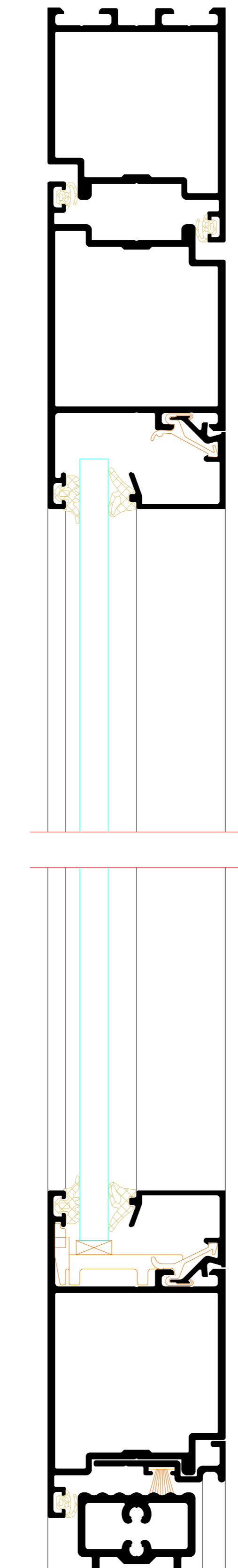

B

mit Klemmschutz
With finger-trap
protection

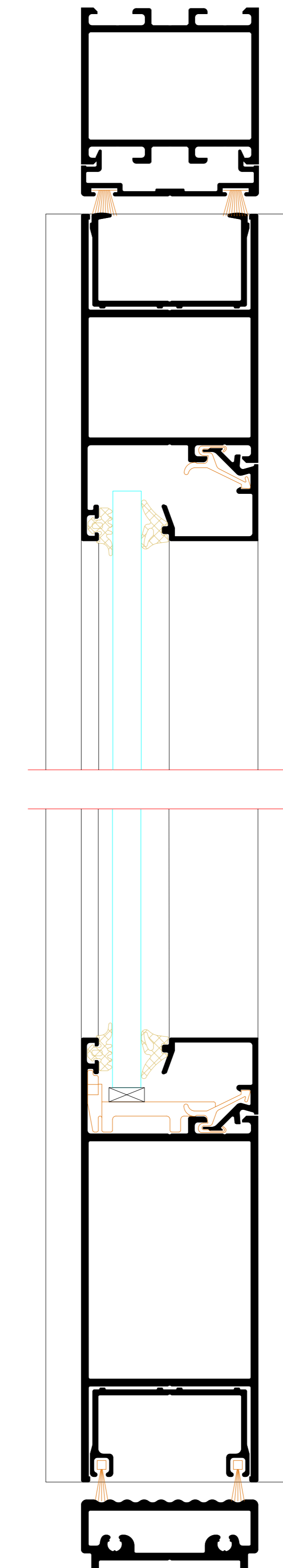

| NO. | DATE | ISSUED | REVISION | BY | CHKD BY |
|---|------|--------|----------|----|---------|
| 001 | 2024 | 01 | 01 | 01 | 01 |
| <p>Riva Elementschelle Riva LHM section details</p> <p>Tür RIVA ADS 50 NI Außen öffnend Door RIVA ADS 50 NI outward opening</p> | | | | | |
| <p>BENEDICT + RIVA <small>BENEDICT - RIVA GmbH Helmholtzstrasse 19 42699 Solingen, Germany</small></p> | | | | | |

Zweiflügelige Tür
Double-leaf door

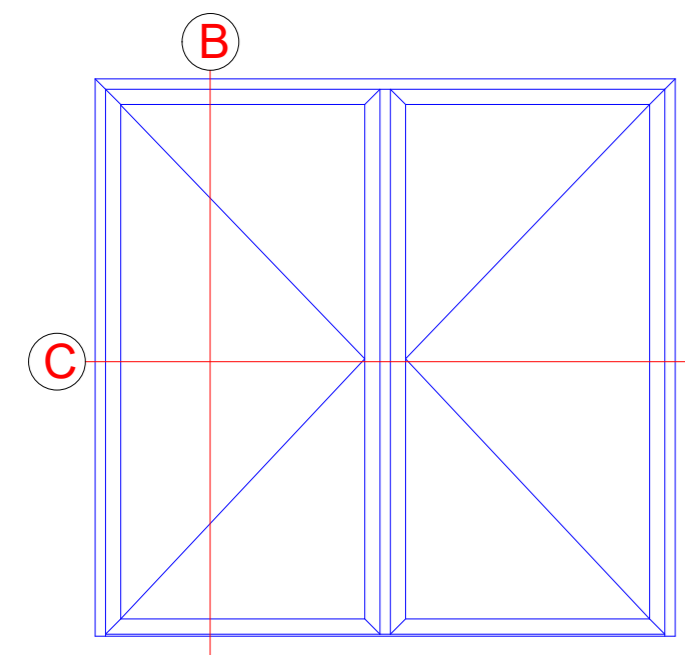

C

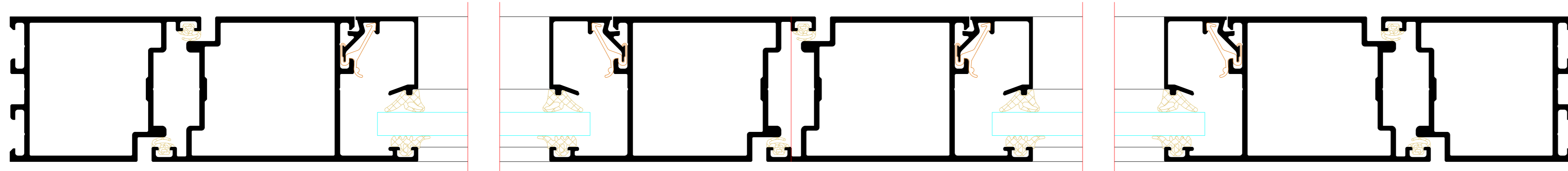

C

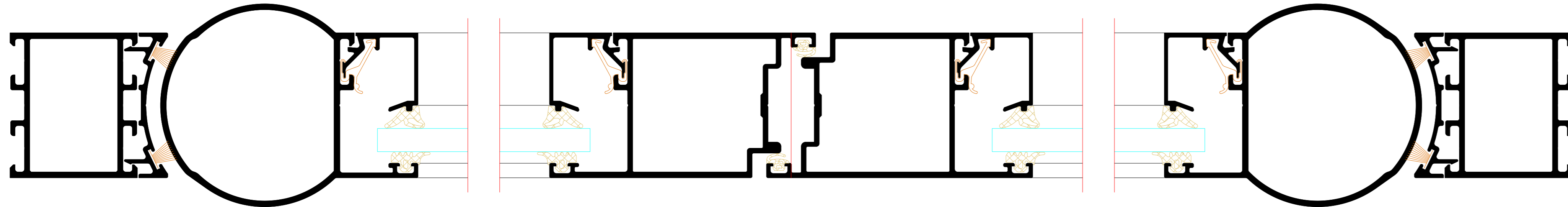

B

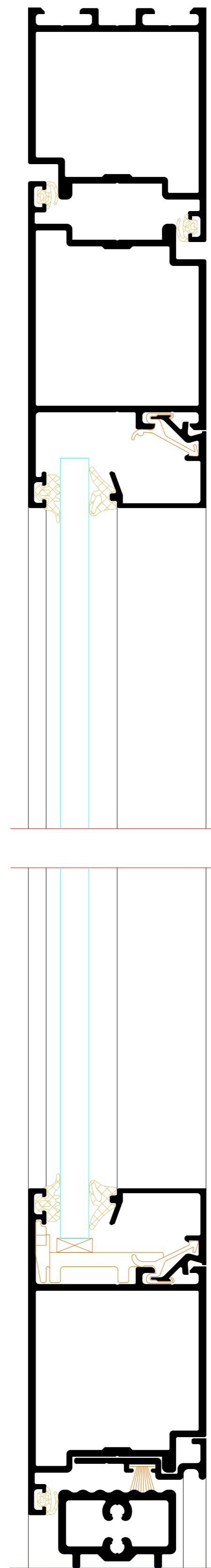

B

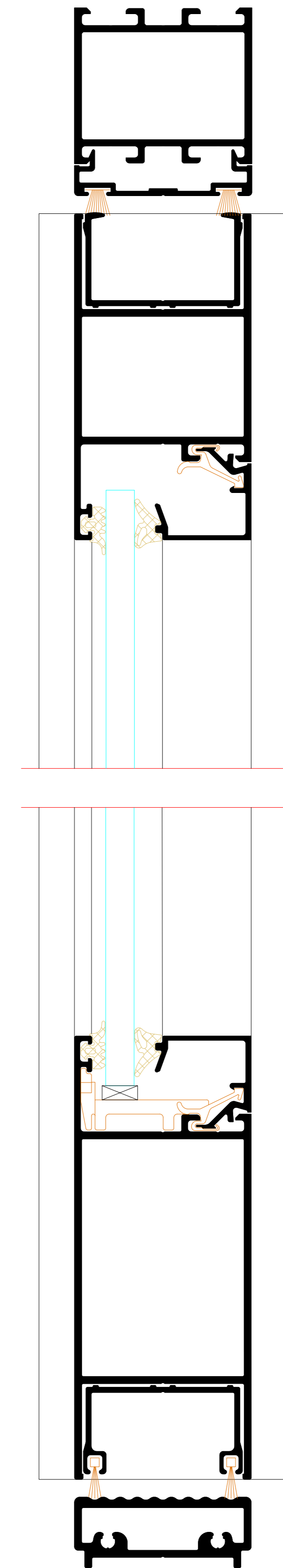

mit Klemmschutz
With finger-trap
protection

| NO. | DATE | REVISION | BY | CHECKED | GROUP |
|---|------|----------|-----|---------|-------|
| 001 | 2024 | 01 | ... | ... | ... |
| <p>Riva Elementbuchreihe Riva LHM section details</p> <p>Projekt Tür RIVA ADS 50/N Außen öffnend Door RIVA ADS 50/N outward opening</p> | | | | | |
| <p>BENEDICT + RIVA <small>BENEDICT - RIVA GmbH Helmholtzstrasse 19 42699 Solingen, Germany</small></p> | | | | | |

Zweiflügelige Tür mit Festfeld
 Double-leaf door with fixed light

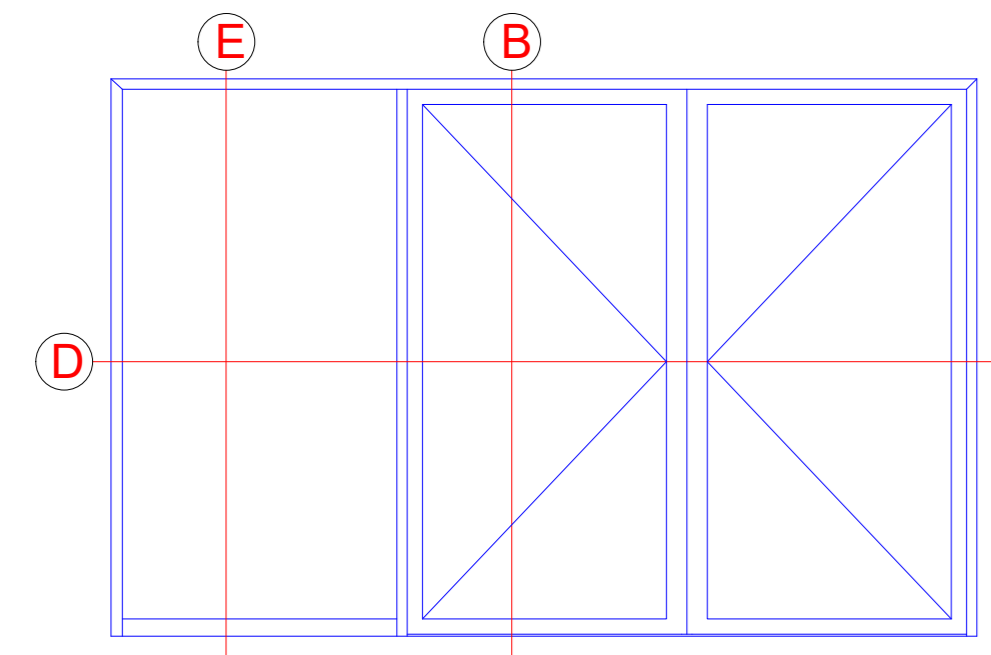

D

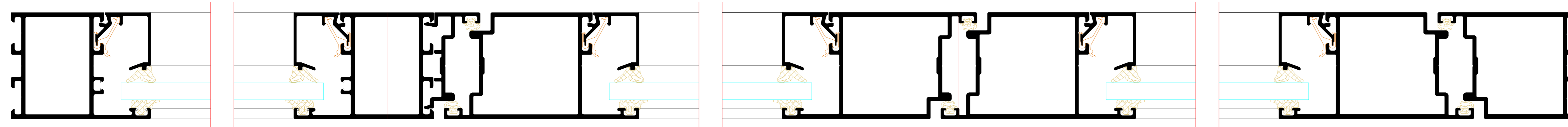

E

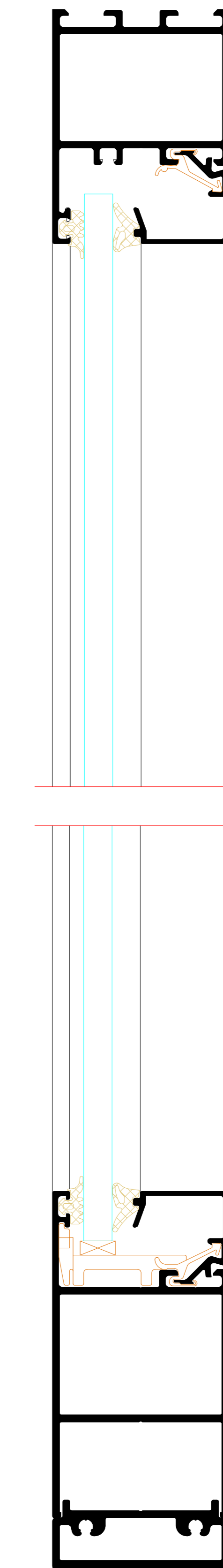

B

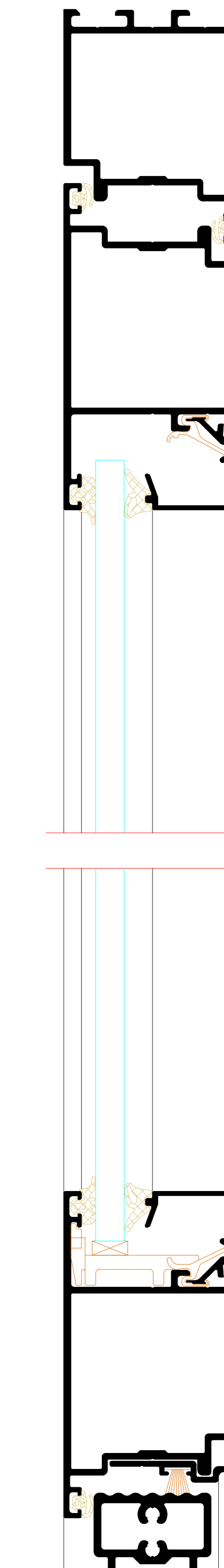

| | | | | |
|---|------|-----------------|----|------------|
| NO | DATE | DESCRIPTION | BY | CHECKED BY |
| 001 | 2024 | Initial release | MB | MB |
| <p>Project: Riva Elementarchelle Riva Unit section details</p> <p>Client: To RIVA ADS 50/50 Außen öffnend Door RIVA ADS 50/50 outward opening</p> | | | | |
| <p>BENEDICT + RIVA <small>BENEDICT - RIVA GmbH Hermannstraße 14 02629 Leipzig, Germany</small></p> | | | | |

Einfügelige Tür mit Oberlicht
 Single-leaf door with toplight

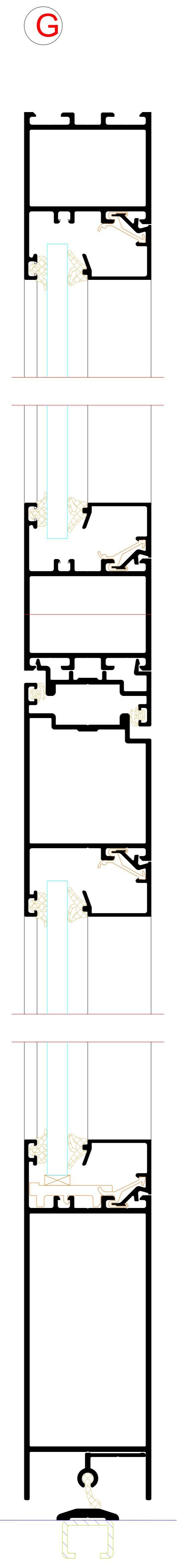
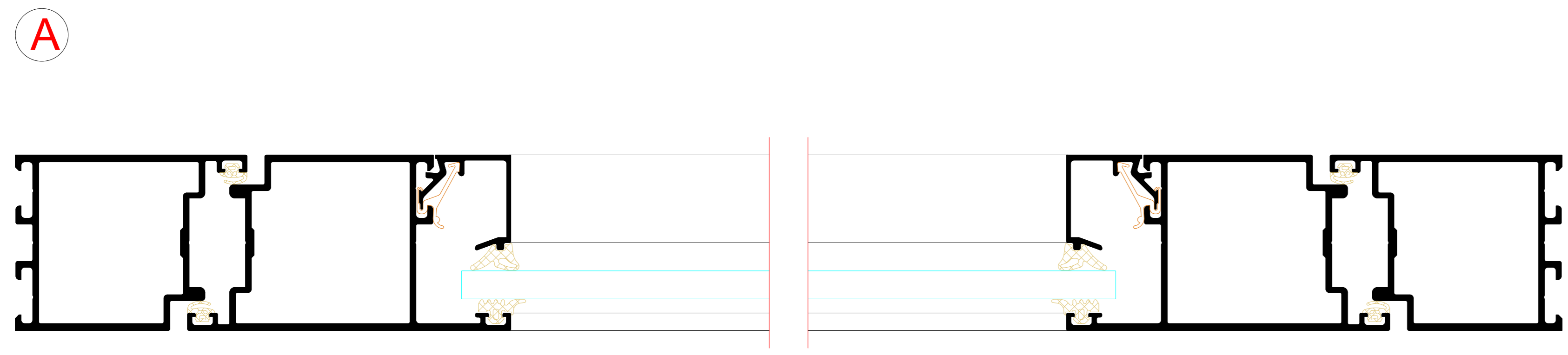
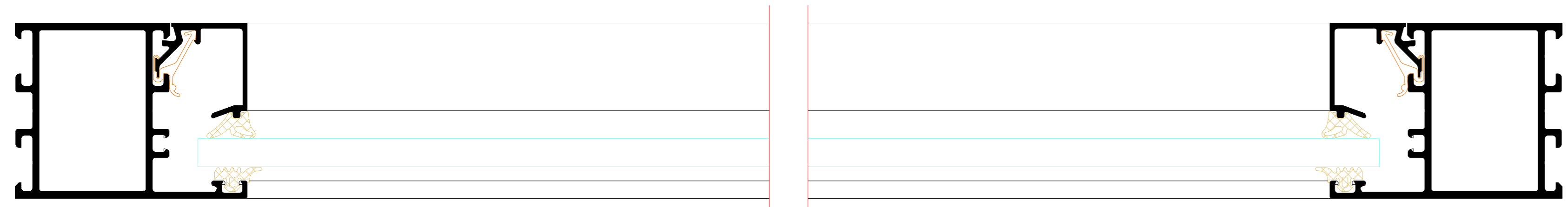
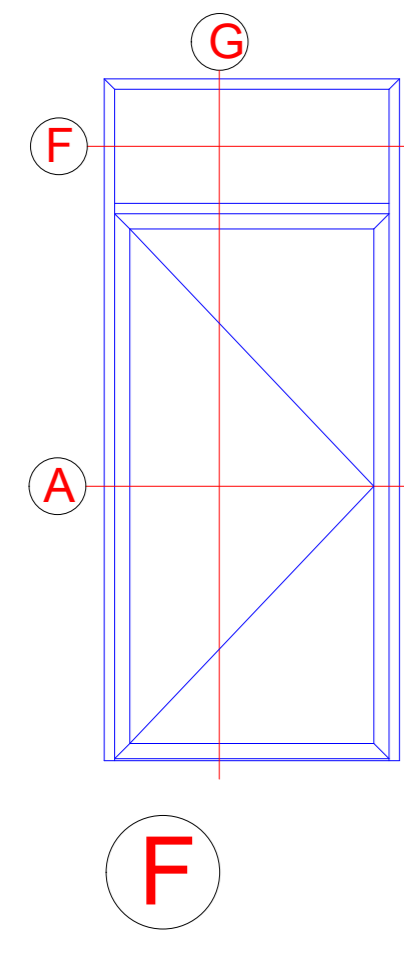

| NO. | DATE | REVISION | BY | CHECKED BY |
|---|------|----------|-----|------------|
| 001 | 2024 | 01 | ... | ... |
| <p>Riva Elementschelle Riva LHT section details</p> <p>Tür RIVA ADS 50 NI Außen öffnend Door RIVA ADS 50 NI outward opening</p> | | | | |
| <p>BENEDICT + RIVA BENEDICT + RIVA GmbH Hermannstraße 11 68504 Ludwigshafen, Germany</p> | | | | |

Einflügelige Tür mit Festfeld
Single-leaf door with fixed light

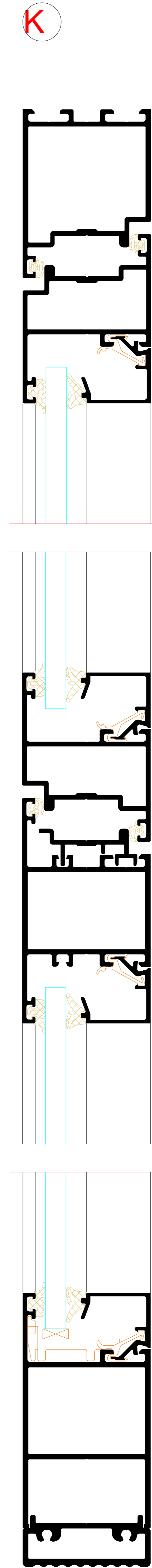
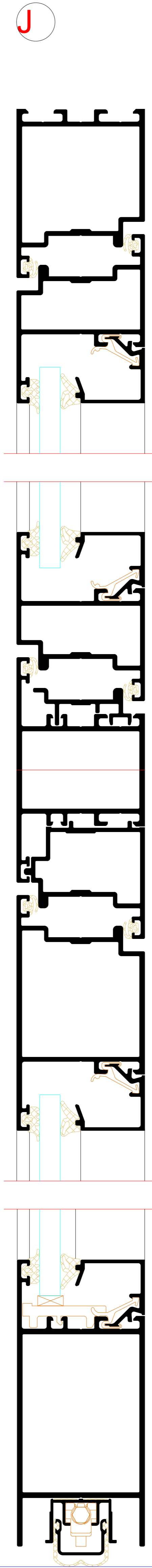
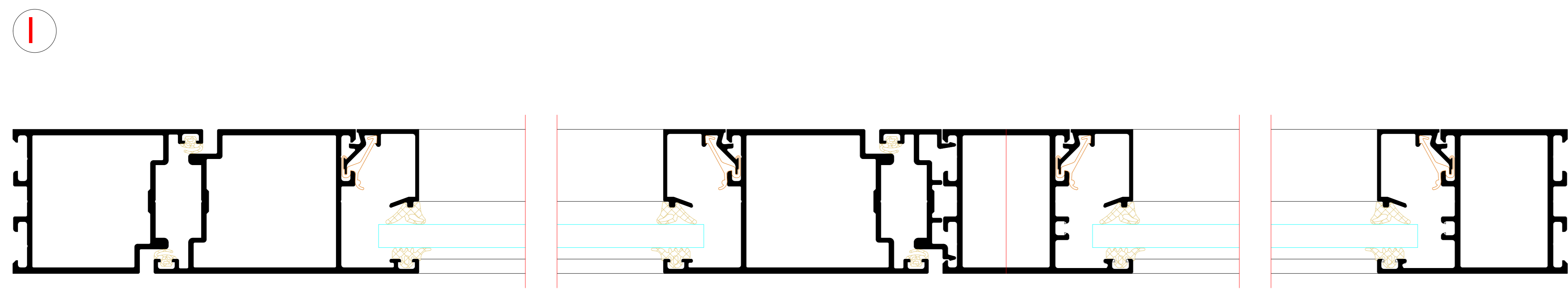
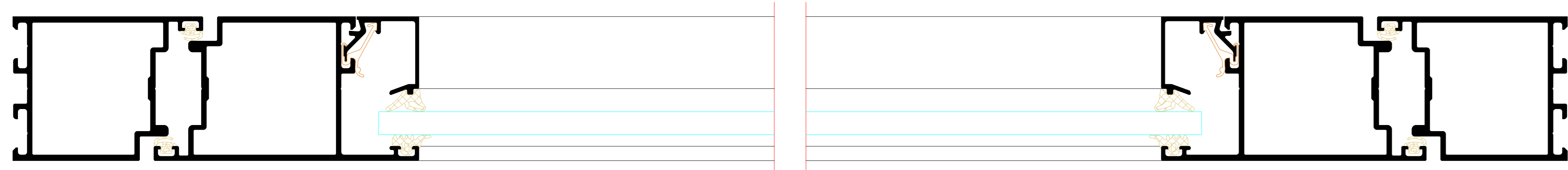
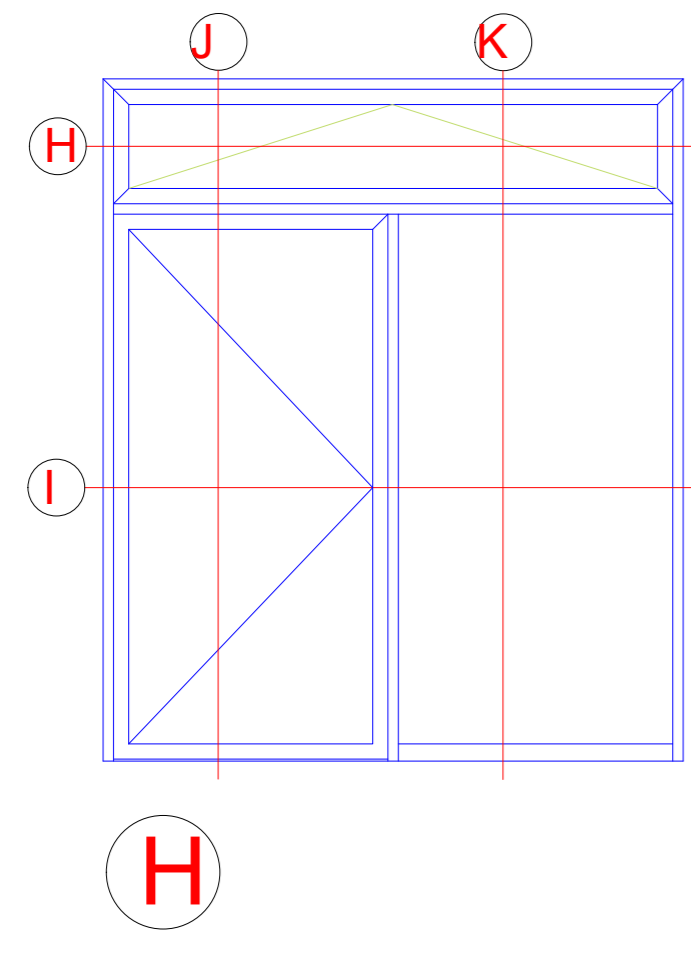

| NO. | DATE | ISSUED BY | CHECKED BY | APPROVED BY |
|--|------|-----------|------------|-------------|
| 1 | 2024 | J. Doe | M. Smith | A. Brown |
| <p>BENEDICT + RIVA <small>BENEDICT - RIVA GmbH Helmholtzstraße 19 42699 Solingen, Germany</small></p> | | | | |

Zweiflügelige Tür mit Festfeld und Oberlicht
 Double-leaf door with fixed light and toplight

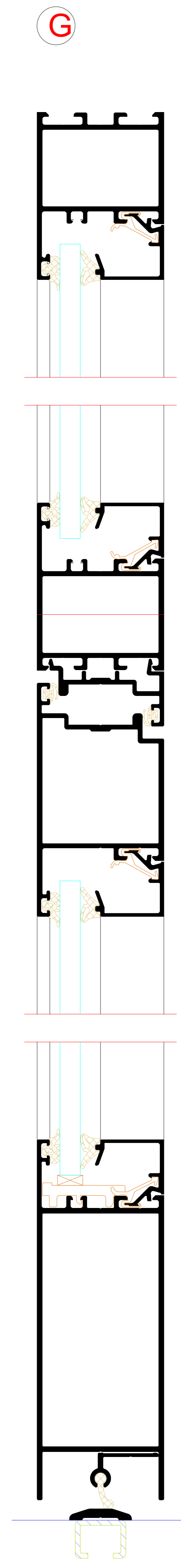
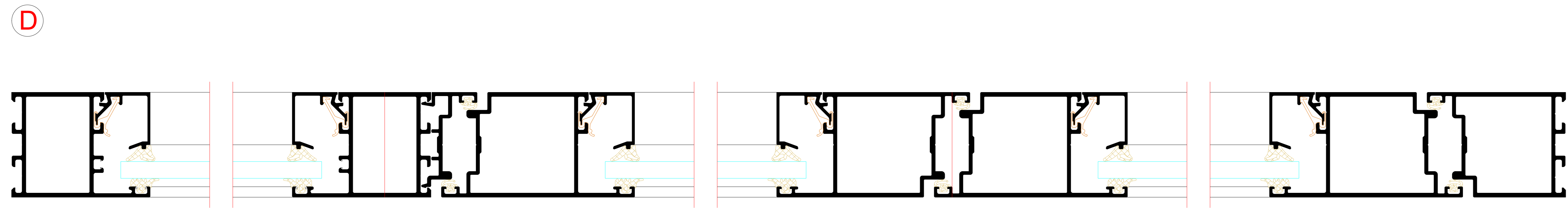
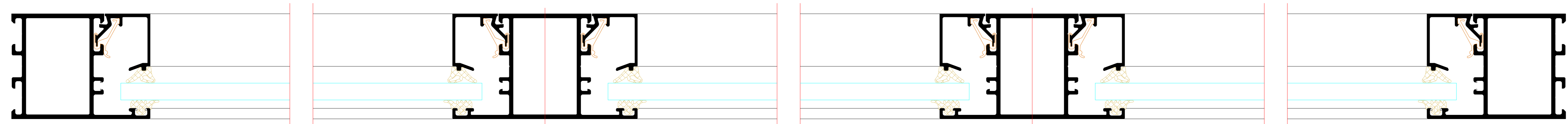
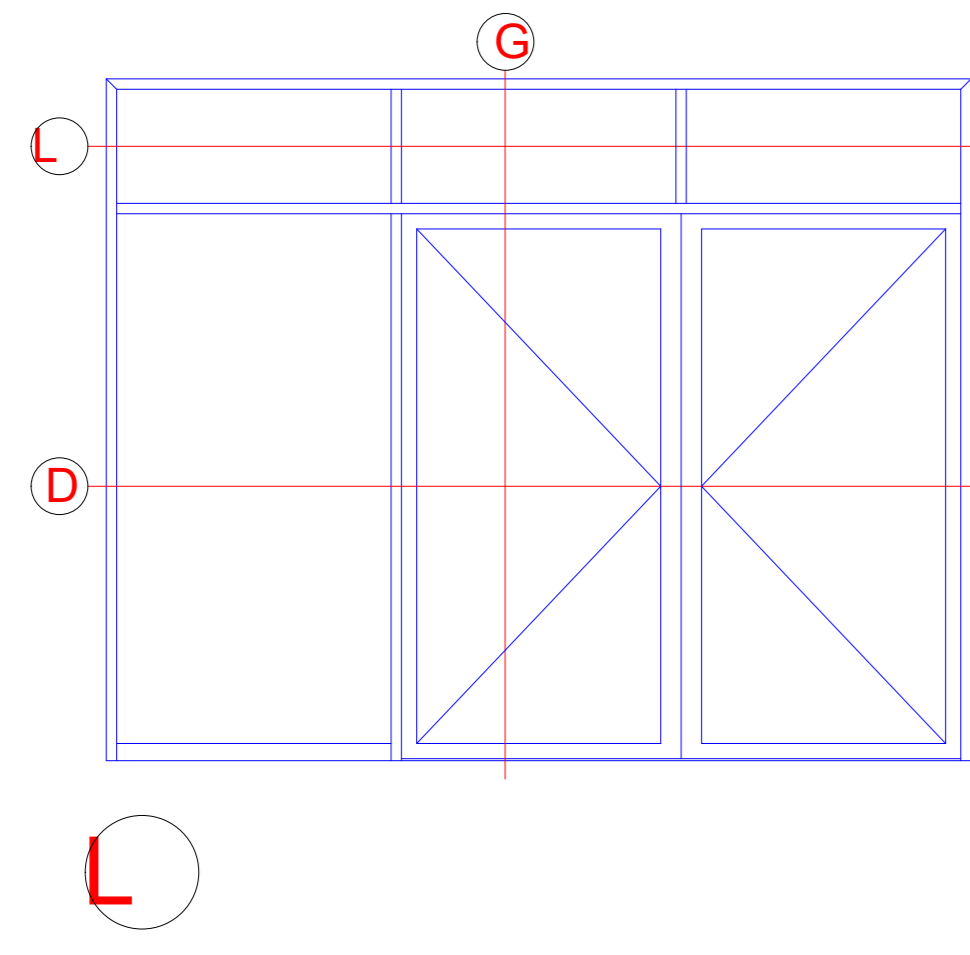

| NO. | DATE | REVISION | BY | CHECKED BY |
|--|------|----------|-----|------------|
| 001 | 2024 | 01 | ... | ... |
| Riva Elementschelle Riva LHT section details Tür RIVA ADS 50 NI Außen öffnend Door RIVA ADS 50 NI outward opening | | | | |
| BENEDICT + RIVA ... | | | | |

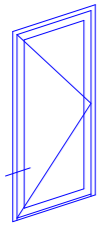

Blendrahmenprofil
Outer frame profile

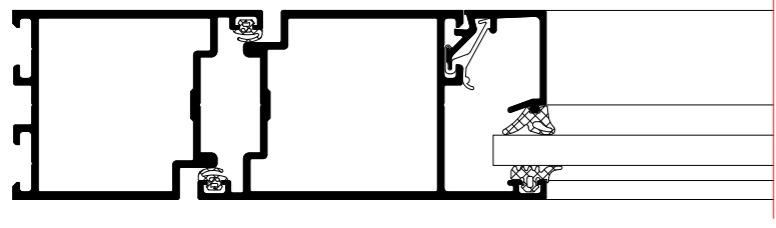

66

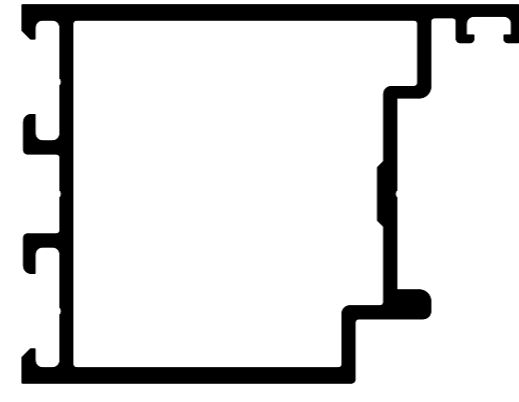

34

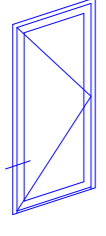
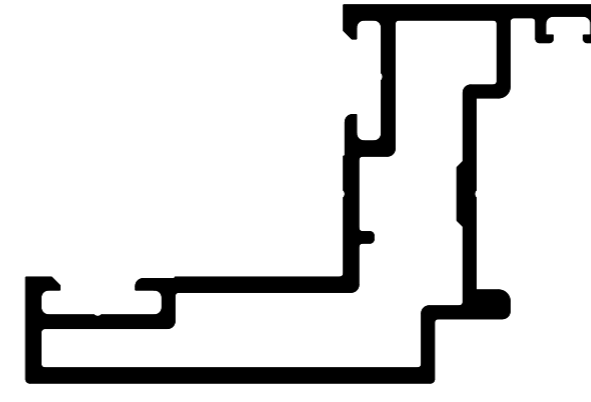

Flügelprofil
Vent profile

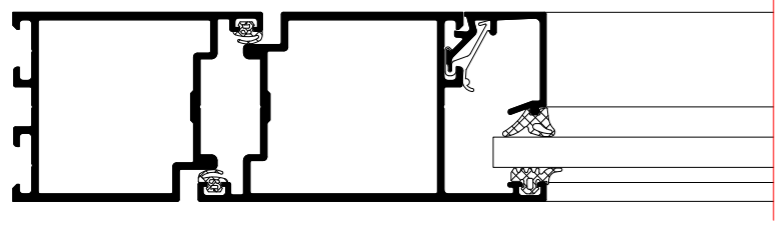

66

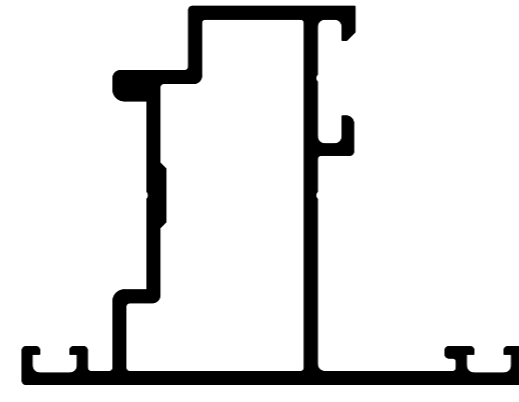

92

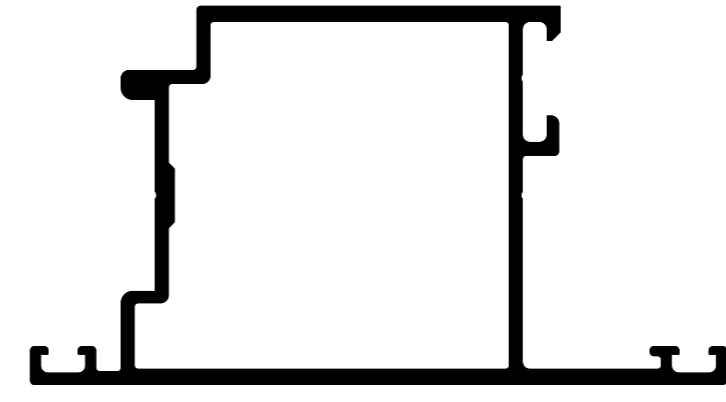

92

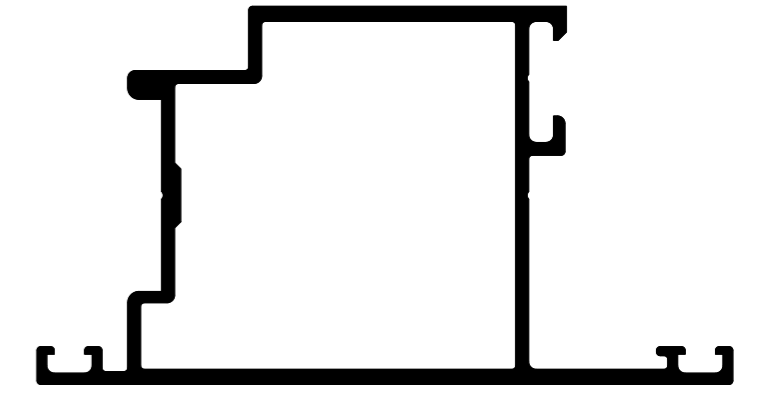

120

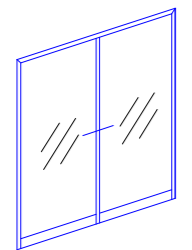

Riegel / Pfosten
Transom/mullion

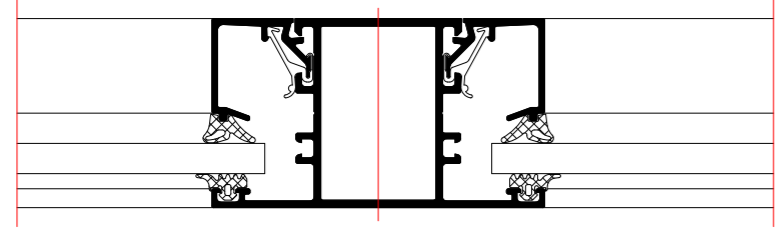

200



88

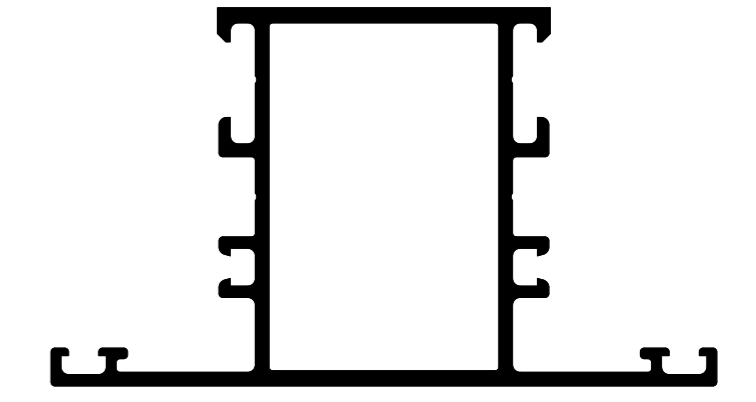

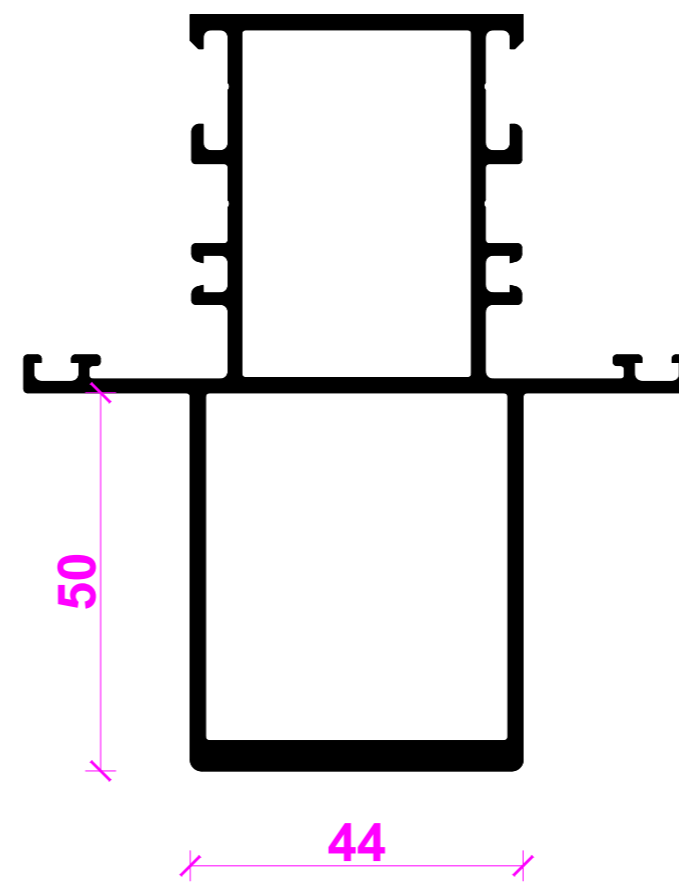
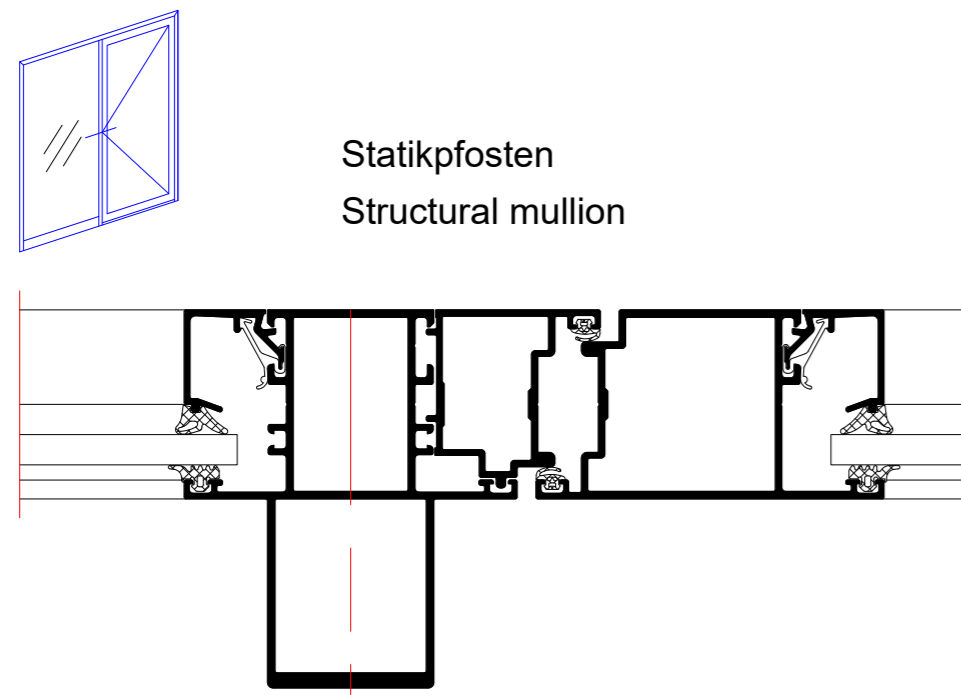
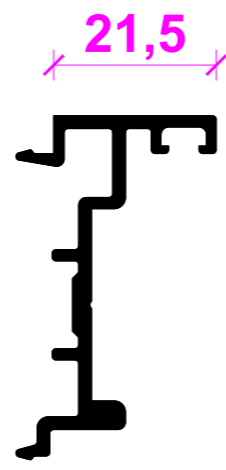
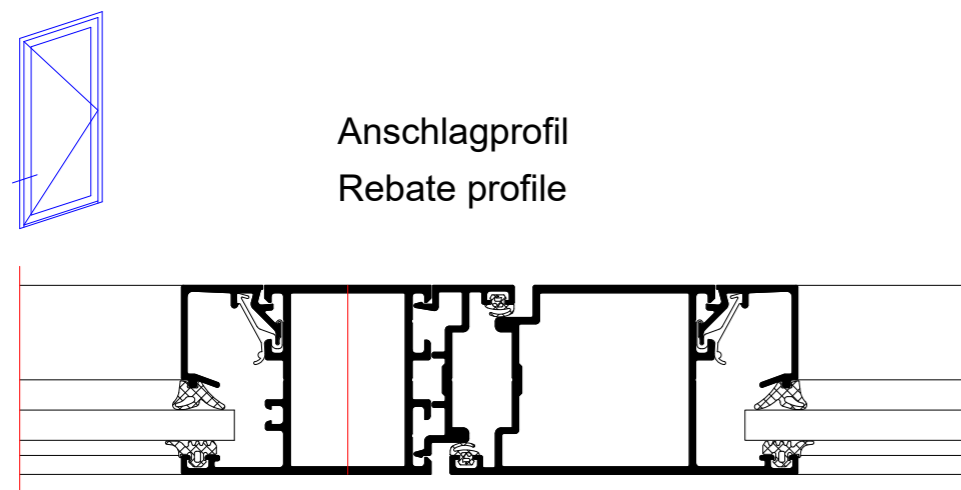
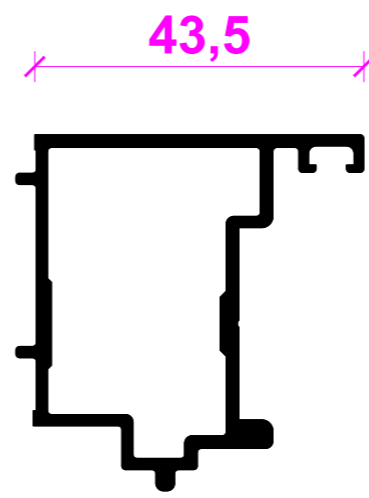
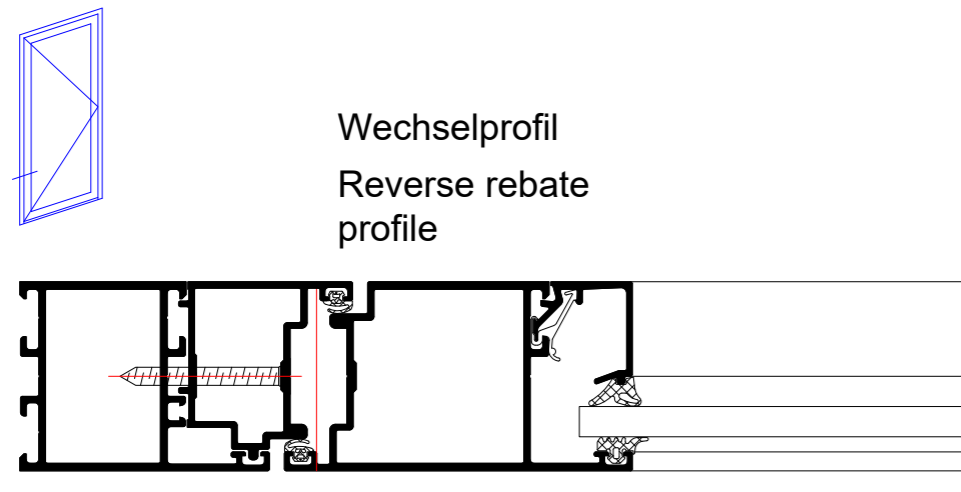
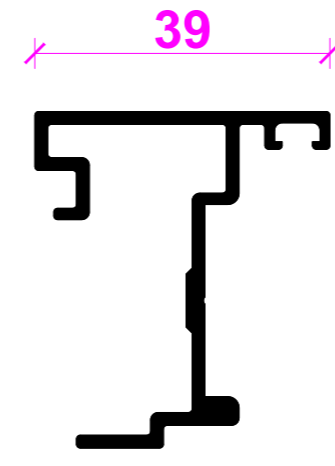
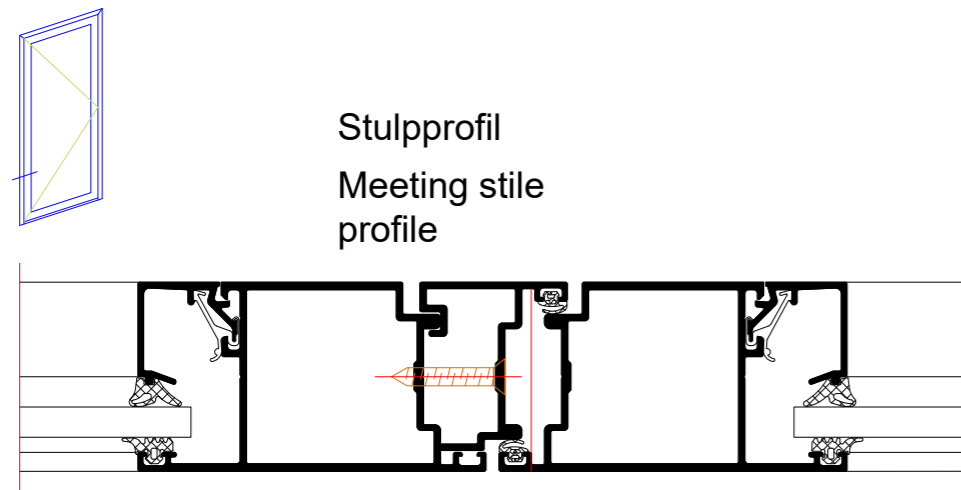

| INDEX | DATE | ANMERKUNG | GEZEICHNET | GEPRÜFT |
|-------------------------------------|--------|-----------|-------------|-------------|
| INDEX | DATE | CHANGE | DESIGNED BY | CHECKED BY |
| PLANSTATUS | | | | |
| PLAN DATUM | | | | |
| Riva Profilsysteme | | | | |
| Riva Profile systems | | | | |
| PROJEKT | | | PROJEKT NR. | |
| Tür RIVA ADS 50.Ni Außen öffnend | | | | |
| Door RIVA ADS 50.Ni outward opening | | | | |
| KUNDEN | | | PROJEKT NR. | |
| CLIENT | | | | |
| PLANNING | | | | |
| PLANNING | | | | |
| BENEDICT + RIVA | | | | |
| BENEDICT + RIVA GmbH | | | | |
| Röcklestrasse 13 | | | | |
| 04320 Leipzig, Germany | | | | |
| ANSCHLUSSPUNKT | | | | |
| CONTACT PERSON | | | | |
| PLANNING | STATUS | PLANNING | MASSSTAB | GEZEICHNET |
| PLANNING TYPE | STATUS | FORM | SCALE | DESIGNED BY |
| | DRAW | | | BY |
| PLANNING | | | | |
| DOCUMENT NUMBER | | | | |

Sockel Festfeld
Sill, fixed light

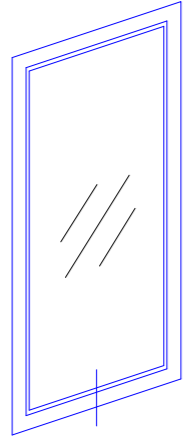

Profile
Profiles

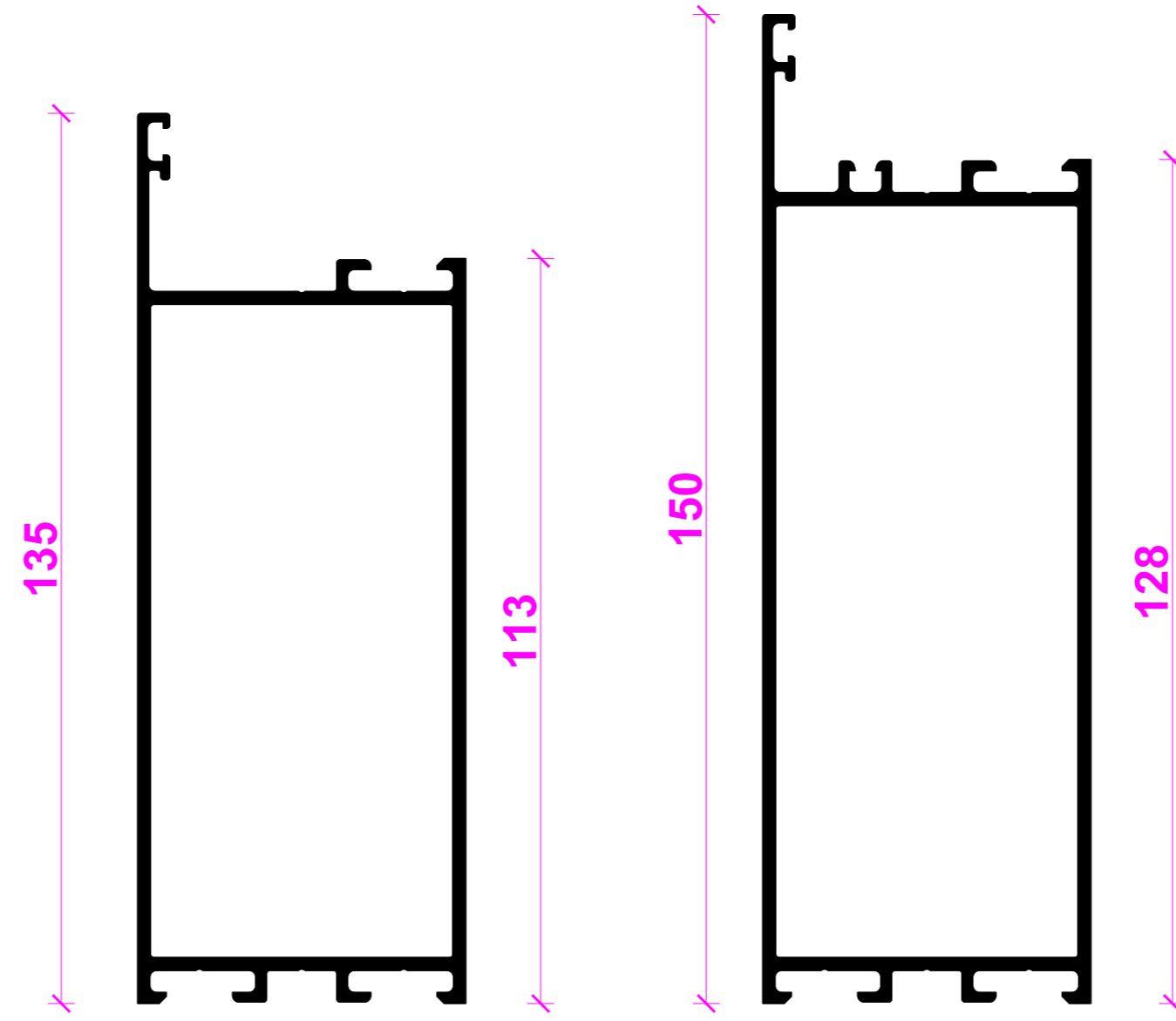
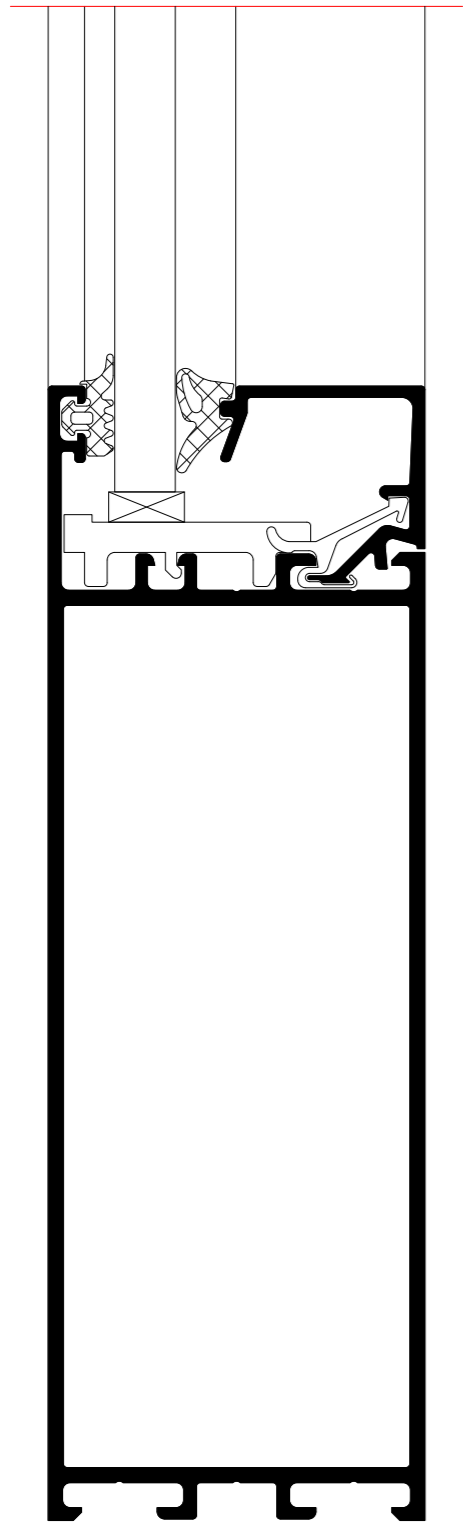

Varianten
Options

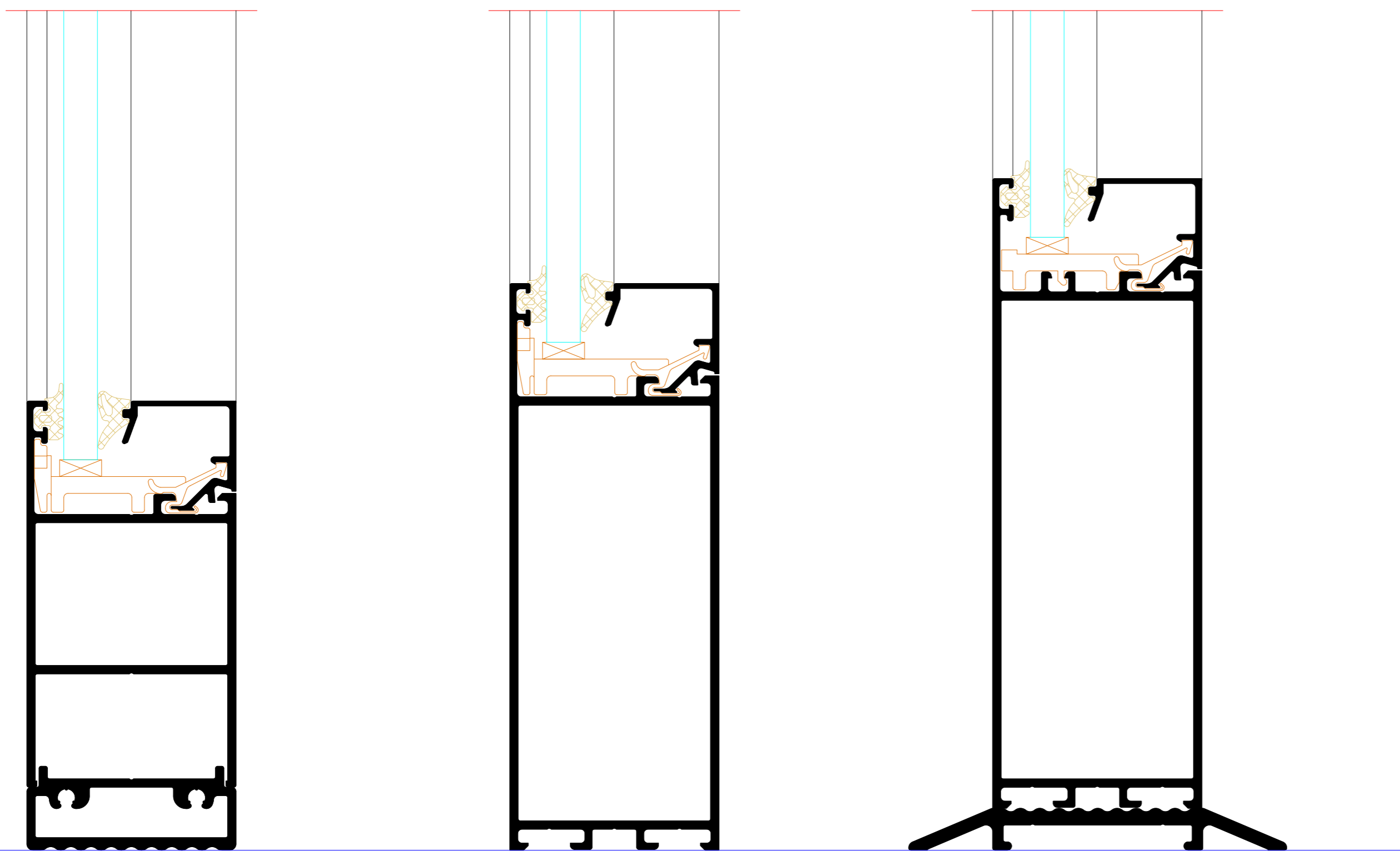

| INDEX | DATE | ÄNDERUNG | GEZEICHNET | GEPRÜFT | |
|-------------------------------------|--------|-------------|-------------|-------------|------------|
| NIECE | DATE | CHANGE | DESIGNED BY | CHECKED BY | |
| PLANWALT | | | | | |
| PLAN CONTROLLER | | | | | |
| Riva Profilsysteme | | | | | |
| Riva Profile systems | | | | | |
| PROJEKT | | | | PROJEKT NR. | |
| PROJECT | | | | PROJECT NO. | |
| Tür RIVA ADS 50.Ni Außen öffnend | | | | | |
| Door RIVA ADS 50.Ni outward opening | | | | | |
| BAUSEITE | | | | | |
| CLIENT | | | | | |
| PLANNER | | | | | |
| BENEDICT + RIVA | | | | | |
| BENEDICT + RIVA GmbH | | | | | |
| Röckelstrasse 13 | | | | | |
| 04229 Leipzig, Germany | | | | | |
| PROJEKT | STATUS | PLANSTADIUM | MASSSTAB | GEZEICHNET | GEPRÜFT |
| PROJECT | STATUS | PLAN STAGE | SCALE | DESIGNED BY | CHECKED BY |
| | | | | | |
| PLANNUMMER | | | | | |
| DOCUMENT NUMBER | | | | | |

Sockel Öffnungselement
Sill, opening unit

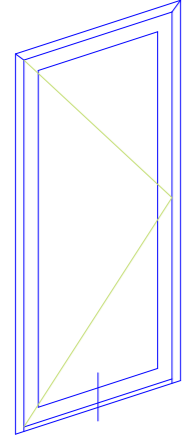

Profile
Profiles

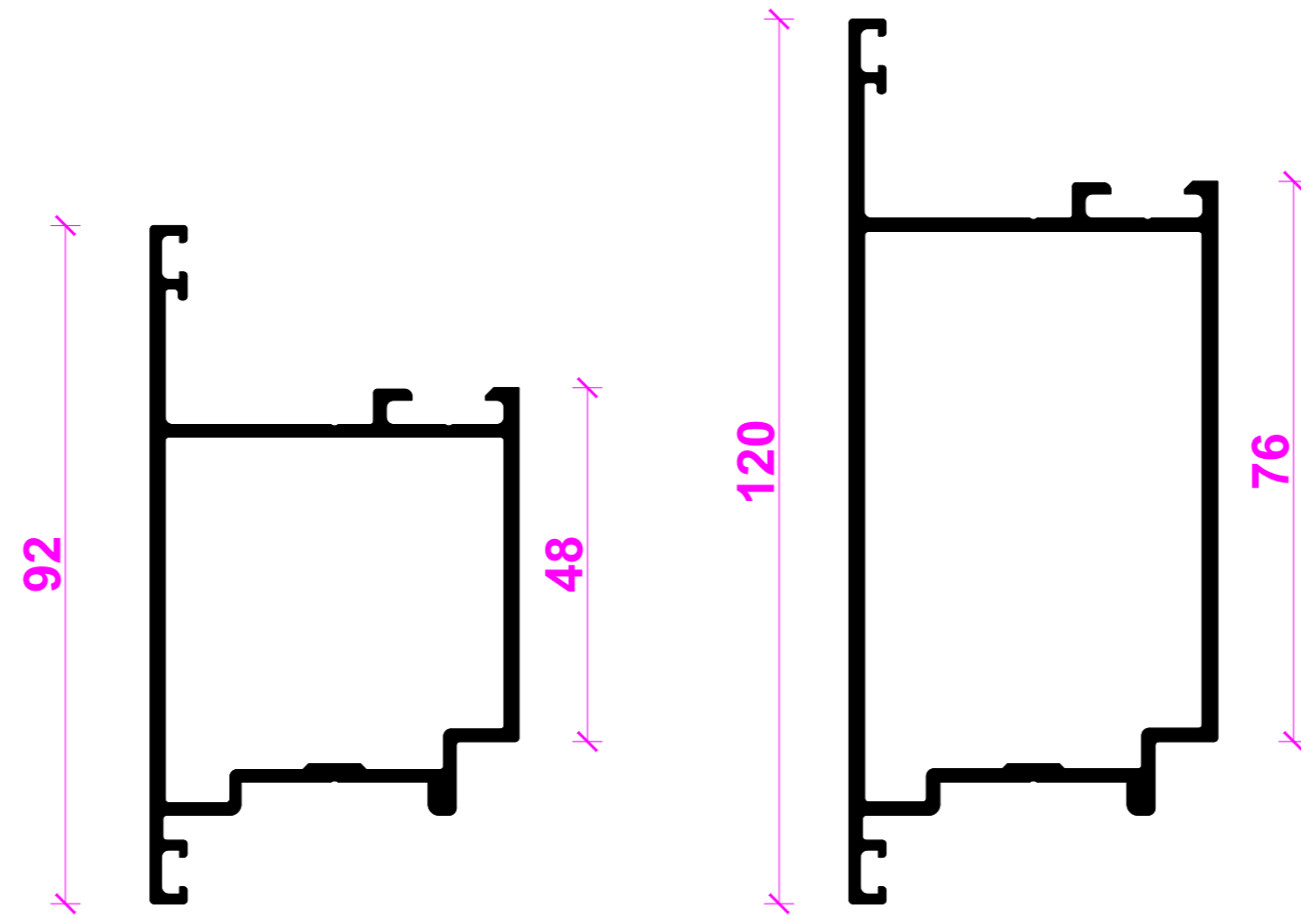
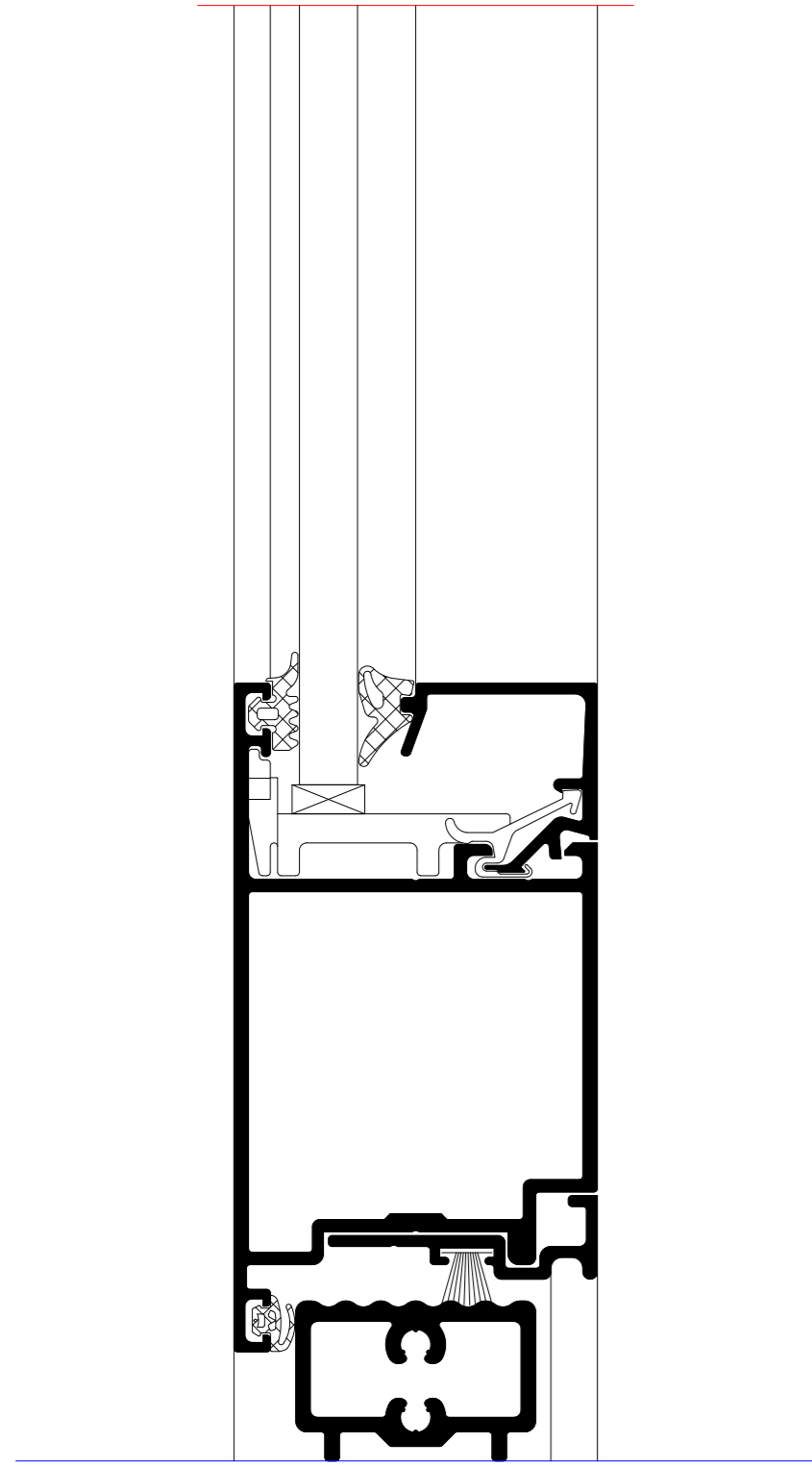

Varianten
Options

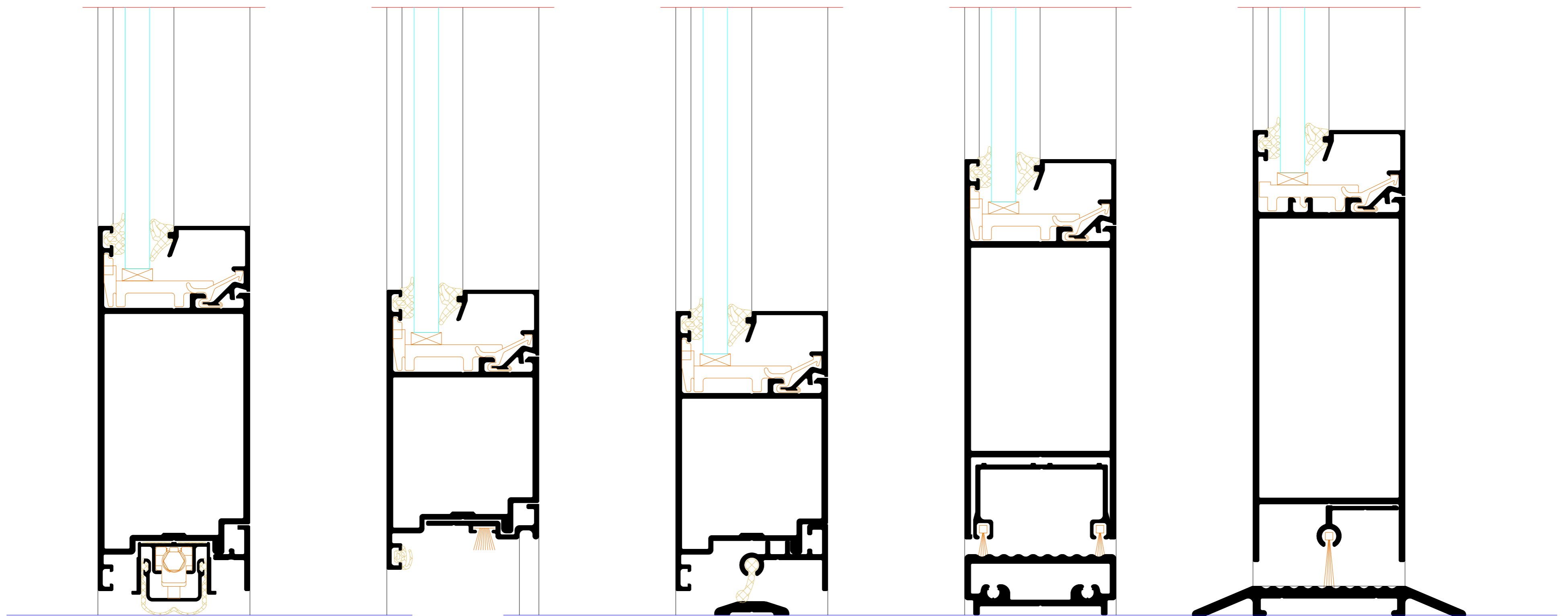

| INDEX | DATE | ÄNDERUNG | GEZEICHNET | GEPRÜFT |
|-------------------------------------|--------|------------------|-------------|------------------------|
| NOSE | DATE | CHANGE | DESIGNED BY | CHECKED BY |
| PLANNRVT | | | | |
| PLAN-CONTENT | | | | |
| Riva Profilsysteme | | | | |
| Riva Profile systems | | | | |
| PROJEKT | | | | PROJEKT NR. |
| PROJECT | | | | PROJECT NO. |
| Tür RIVA ADS 50.NI Außen öffnend | | | | |
| Door RIVA ADS 50.NI outward opening | | | | |
| BAUHER | | | | |
| CLIENT | | | | |
| PLANVERFASSER | | | | |
| PLANNER | | | | |
| BENEDICT + RIVA | | | | BENEDICT + RIVA GmbH |
| | | | | Röselstrasse 13 |
| | | | | 04229 Leipzig, Germany |
| ANSPRECHPARTNER | | Matthias Anstett | | |
| CONTACT PERSON | | | | |
| PLANART | STATUS | PLANFORMAT | MAßSTAB | GEZEICHNET |
| PLANNING TYPE | STATUS | FORMAT | SCALE | DESIGNED BY |
| | DRY | | | DATE |
| PLANNUMMER | | | | GEPRÜFT |
| DOCUMENT NUMBER | | | | CHECKED BY |
| | | | | DATE |